

Stratford Upon Avon High School

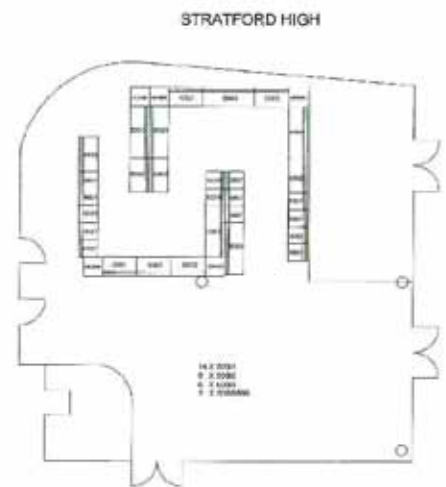

“Our Sixth Form students found the website while re-searching for furniture for the new common room. We are delighted with the design service, the products and the attention given by the staff at Eglin. The company have been very easy to deal with and we are extremely pleased with the finished result.”

Nicholas Chamberlaine Technology College

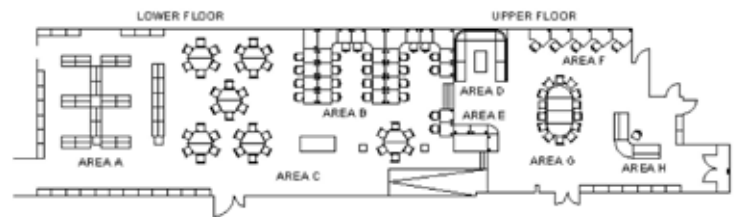
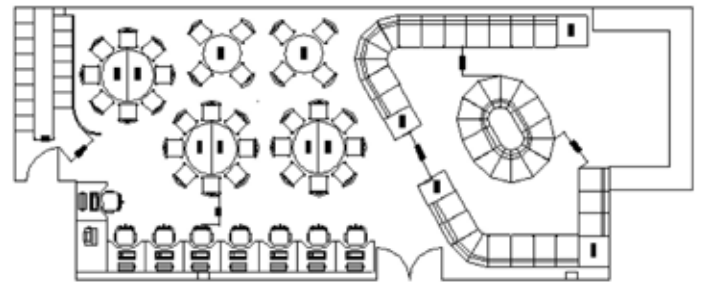

“We at Nicholas Chamberlaine Technology College have worked with Eglin and are very happy with the professional, flexible and reliable service provided. We have found Eglin to be a company that responds promptly and delivers a high level of service that we can rely on.”

St Hilda's CE Primary School - Staff Room

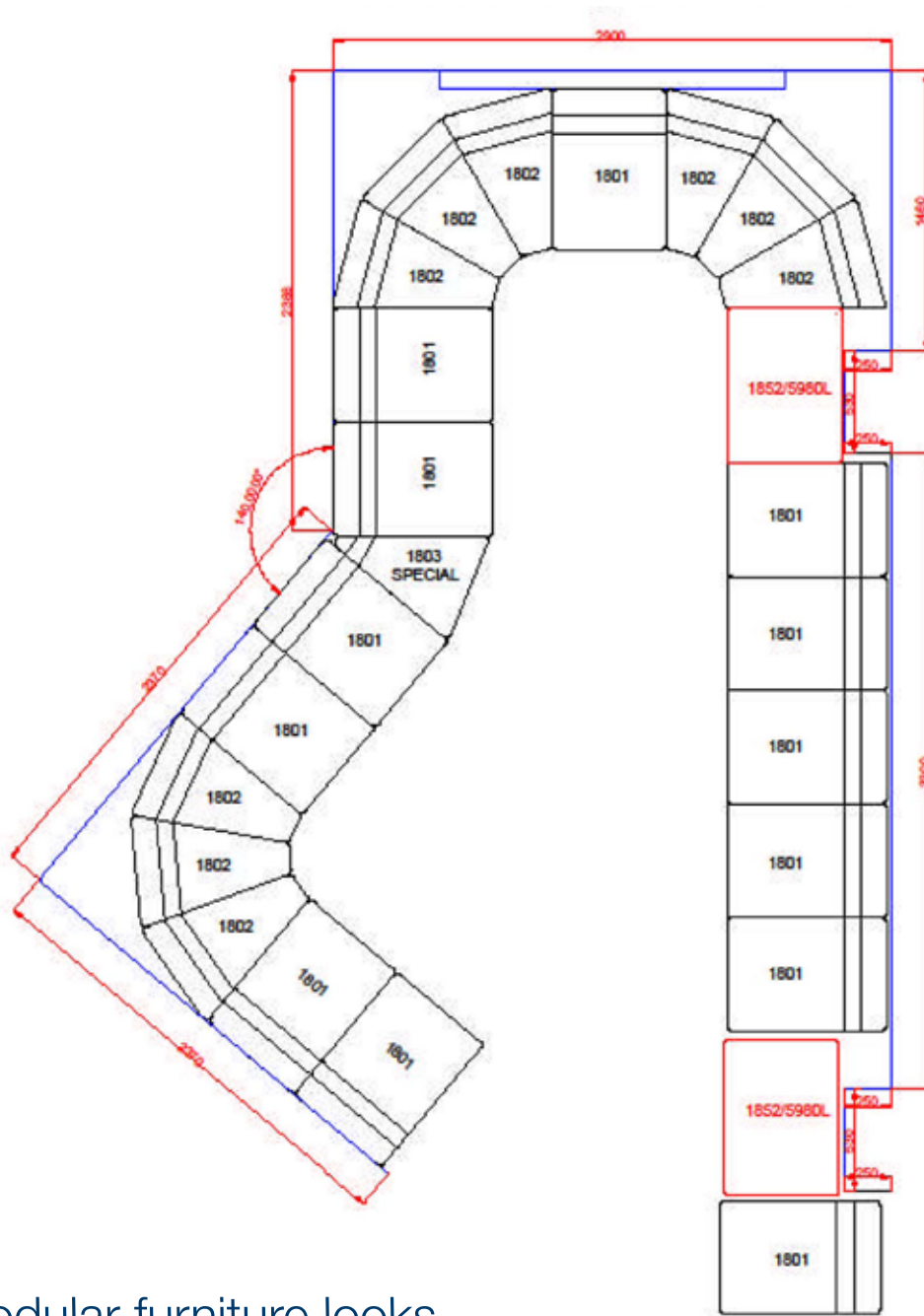

“The modular furniture looks stunning in the updated staff room and fits in to the room perfectly considering the awkward shape!”

Burford School - ITC Room

Burford School - Horseshoe Configuration 1
 32 workstations + 1 Teacher
 1 workstation to be height adjustable
 Storage for equipment to be provided

Revised Drawing Dated 15/12/10

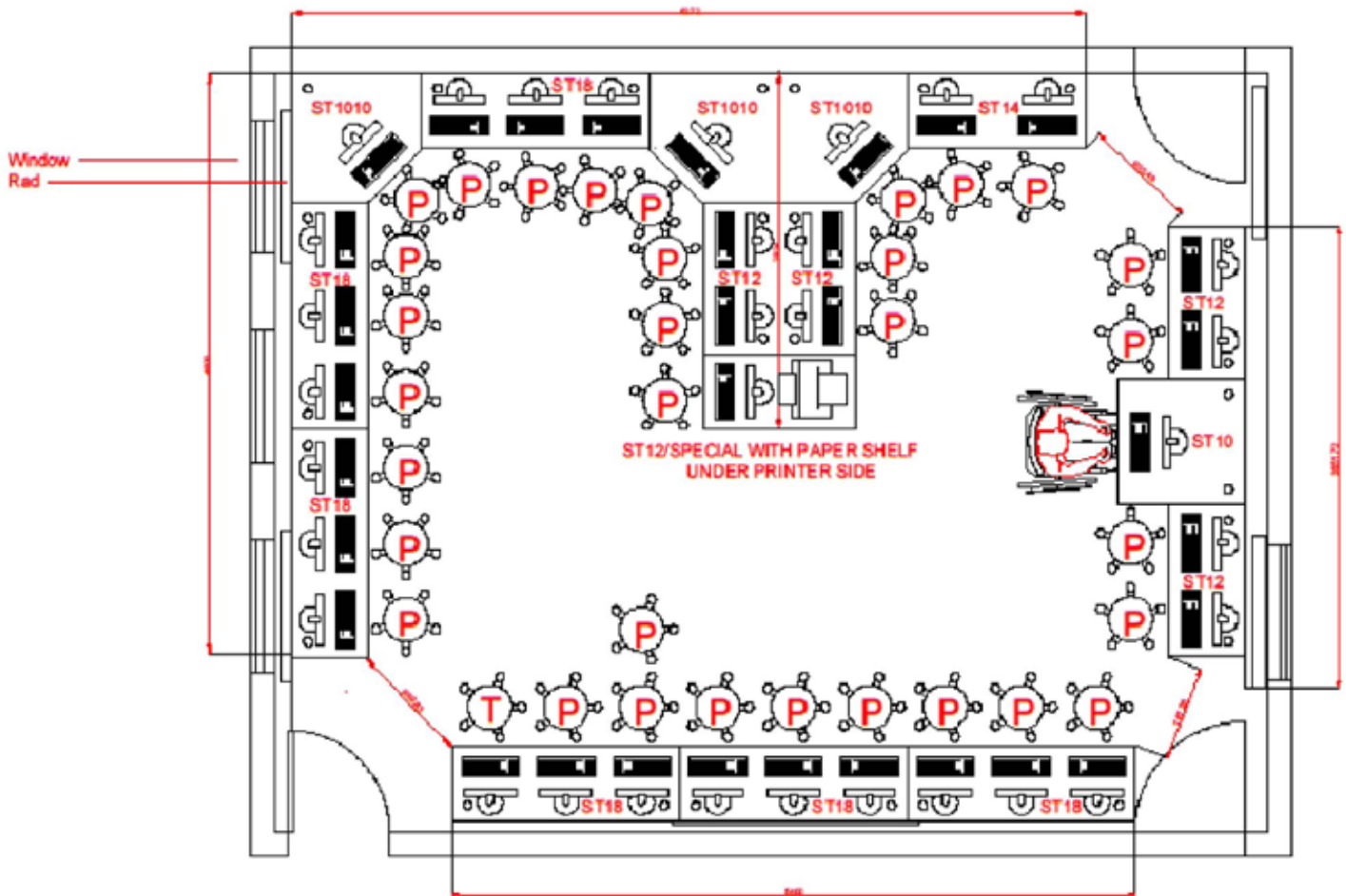

“Just thought I would let you know how great the furniture looks in situ. What a transformation to the room! The furniture defines the space beautifully (the tambour units look great) and I think the layout will work really well.

Thanks for all your help”

Micklefield School - Computer Room

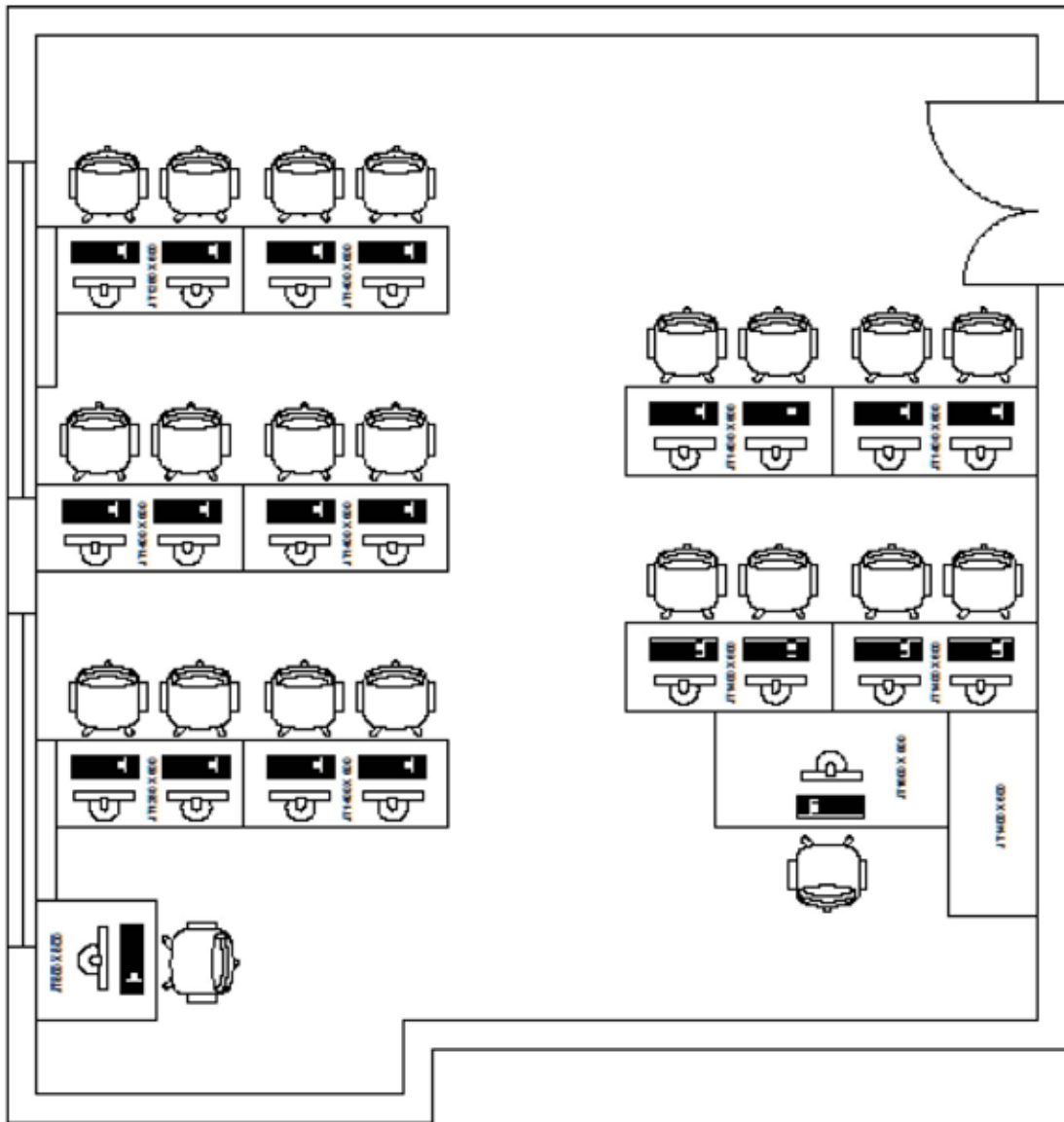

“Thank you for arranging the safe delivery of our new furniture. The computer workstations are being installed as I type and I have no doubt that everyone will be pleased with the results when they return to school.

Thanks again for your help.”

Parkside School - IT Suite

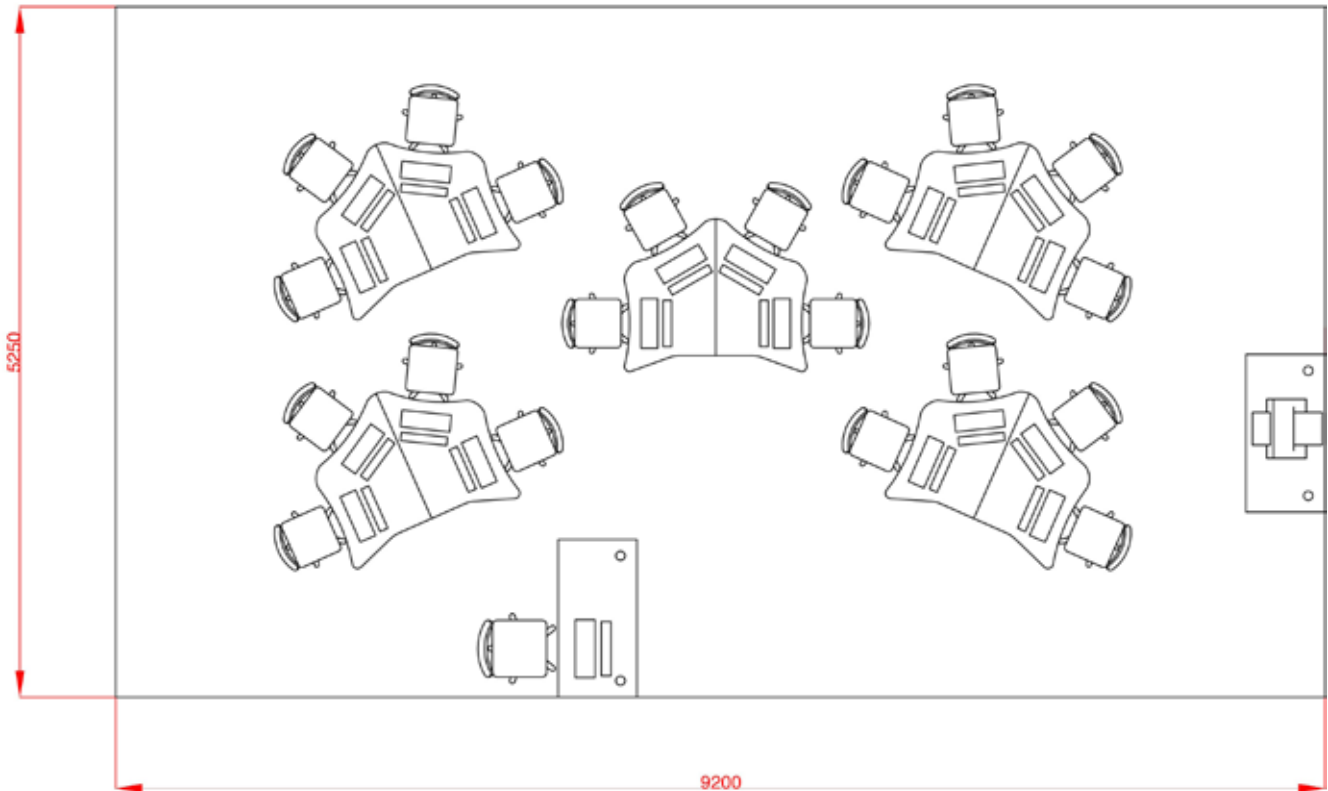

“As a school looking for a cost effective solution for our new IT suite we were recommended to Eglin Furniture. We were looking for a contemporary bespoke design and had difficulty in finding that in the general market place. From brief discussions and rough sketches Eglin worked with us in designing a workstation that met our exacting specification. They achieved a quality build, on time, and within budget. We are delighted with the outcome and have received much positive feedback from our pupils, parents and school governors.”